

X-COM2 Quick Start Guide

Product Details

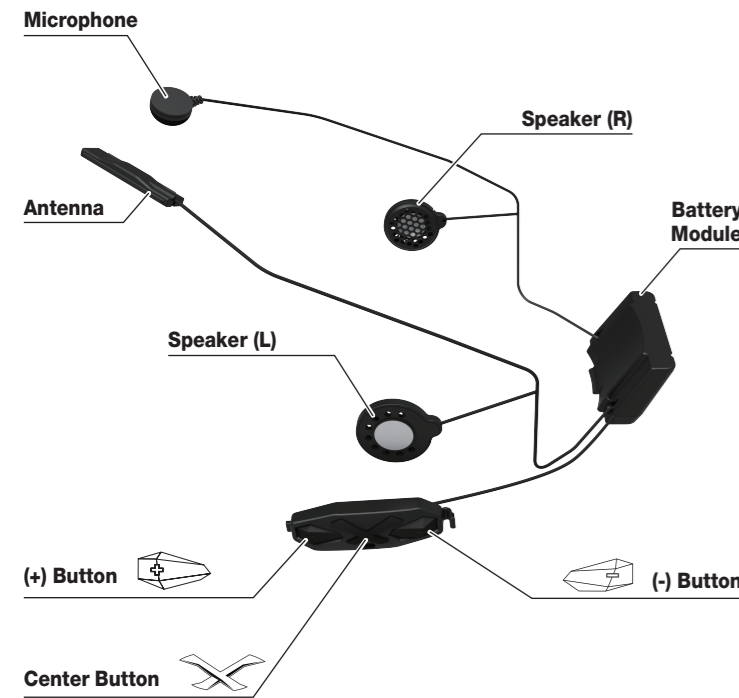

Installation

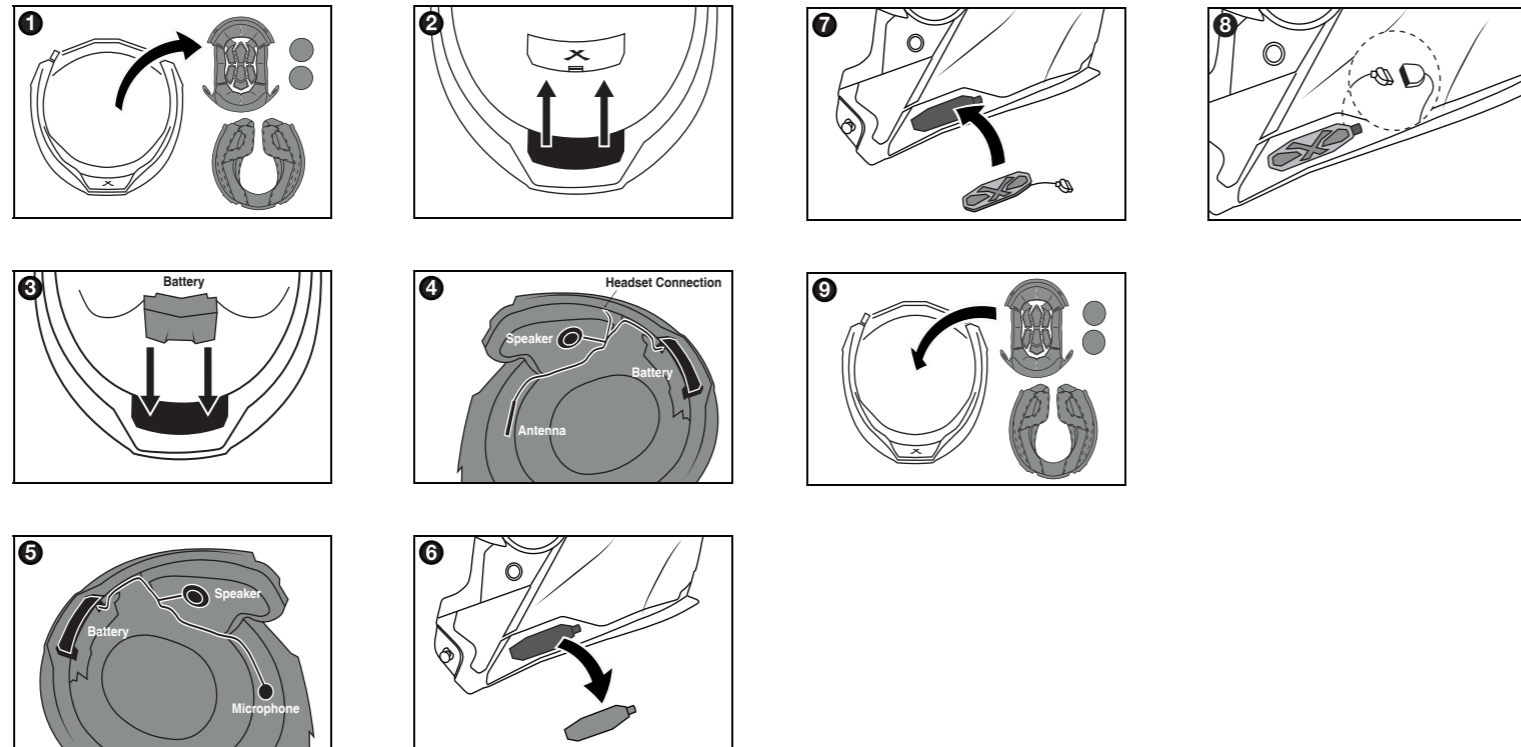

Button Operation



Power On/Off

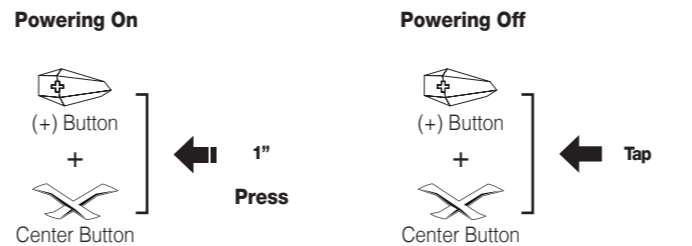

Volume Adjustment



Bluetooth Pairing Phone, MP3 and GPS



Mobile Phone

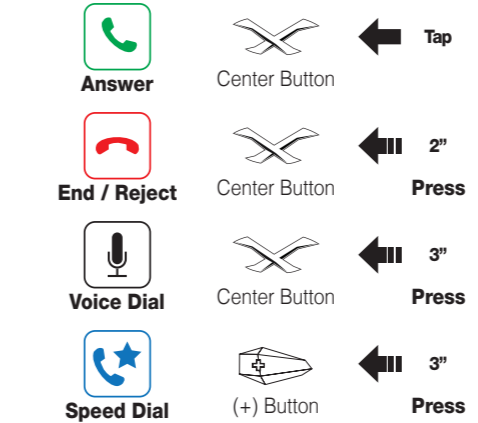

Music

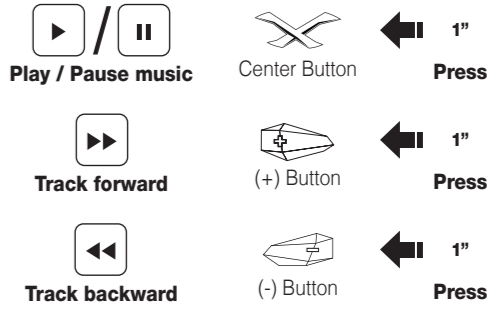

Battery Check

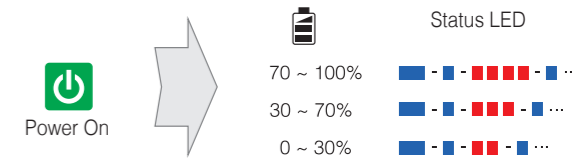

Configuration Menu



Using the Sena Device Manager

Connect the headset to your computer via a USB cable. Launch the Sena Device Manager and click **DEVICE SETTING** to configure the headset settings. For more information on downloading the Sena Device Manager, please visit www.sena.com.

Using the Sena Smartphone App

1. On your smartphone, download the **Sena Smartphone App** for Android (Google Play) or iPhone (App Store). Please refer to www.sena.com/headset-app/ for more details.
2. Pair your smartphone with the headset.
3. Run the **Sena Smartphone App**. Swipe the screen to the right and tap **SETTING** to configure the headset settings.

Intercom Pairing

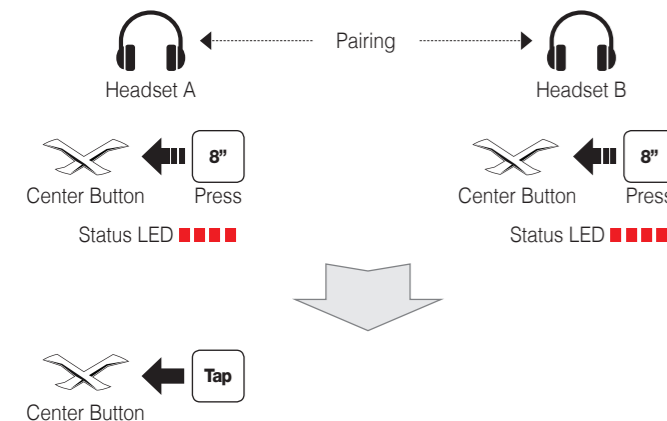

Start / End Intercom

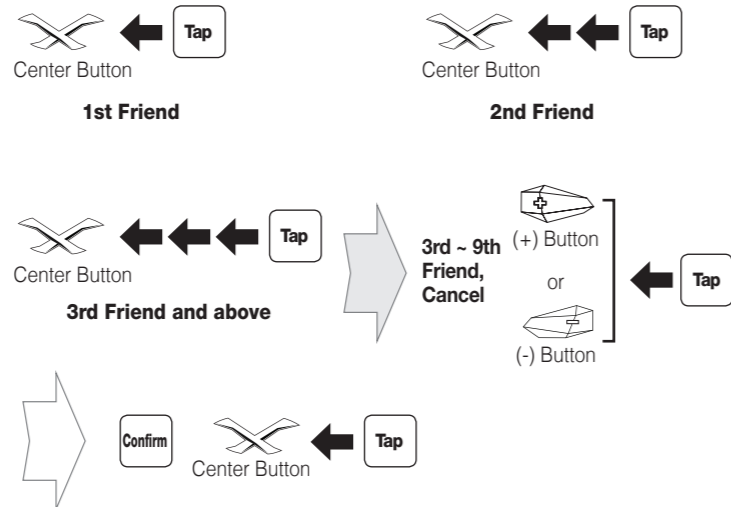

Start / End Group Intercom

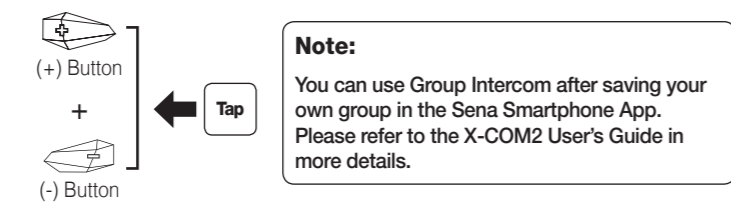

Radio On / Off



Radio Scan Up FM Band

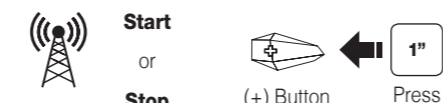

Save to preset while scanning



Radio Seek Station

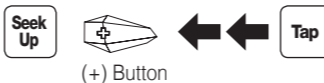

Radio Save and Delete Preset

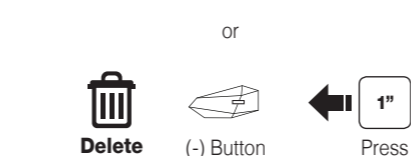
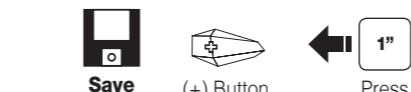

Radio Move to Preset Station



Voice Command

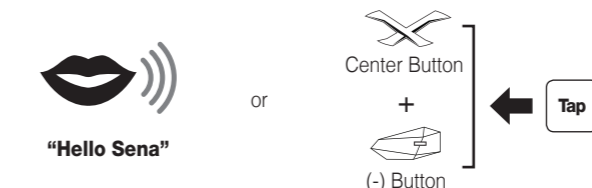

Voice Command	Function
"Music"	Play/Pause music
"FM radio"	FM Radio on/off
"Intercom [one, two, ... , nine]"	Start/End each intercom
"Speed dial [one, two, three]"	Speed dialing

Troubleshooting

Factory Reset

If you want to restore the **X-COM2** to factory default settings, use the **Factory Reset** in the configuration menu. The headset automatically restores the default settings and turns off.

Fault Reset

If the **X-COM2** is not working properly for any reason, reset by gently pushing the pin-hole reset button located next to the Micro USB Power Charging & Firmware Upgrade Port.

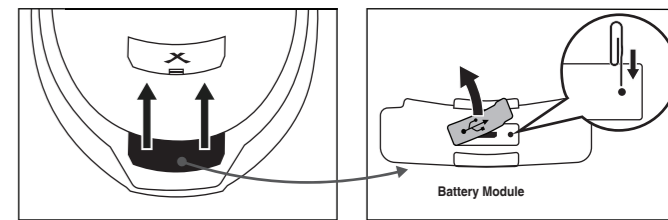

A full version of the manual is downloadable at www.nexx-helmets.com.



NEXXPRO, Fábrica de Capacetes, S.A.
www.nexx-helmets.com
 Customer Support:
support@nexxpro.com