

Installation Guide

Check all componets

*Please check all components are included in the package before you go through.

XENOLEN

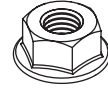
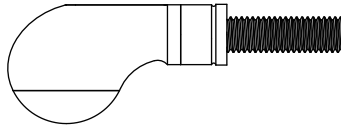

Dressup sticker x 1

Arrow x 1

M8 self-locking nut x 1

*Flashing-Relay is not included in, please ask local dealer for your-bike compatible relays.

Mounting

*Ask local dealer for assistance if you are not familiar with mechanical engineering.

*Any damage will occur due to inappropriate installation or assembly.

Separate the wire between original indicators and your bike, make sure the length is just right in the position. Disassemble the original indicator from your bike, and then mount the indicator into the position. With included M8 self-locking nut, please fasten the indicator tightly and adjust the lighting direction .

- + You can find a subtle indicator-spacer in dealer shop for better fitment between the indicator and your bike.
- + For a safety ride, always make sure the lighting direction is horizontal and parallel to your bike.
- + More information please refer to www.eur-lex.europa.eu.

Electrical Connection

*Ask local dealer for assistance if you are not familiar with mechanical engineering.

*Any damage will occur due to inappropriate installation or assembly.

Find the circuit diagram to the original wires in the wire loom for your bike, and connect to the indicator. The red wire marked as (+) , please connect the wire to plus pole on the cut wire. The black wire marked as (-), please connect the wire to minus (ground) pole on the cut wire. If you have a relay in between, please connect the wire according to it's functional design.

- + You may need a pair of flashing-relay for proper flashing frequency.
- + Please make sure all wiring connection is under water-proof protection.

TEST

*All operation and usage on road driving should always follow the law restricted by each countries After installing the indicator and finishing the wire connecting (between relay) from the indicator to bike. You can give a quick test to the indicators. With correct function you can see comfortable flash with turn signal. Please make sure the indicating function is right before your every trip, this is for your safety driving.

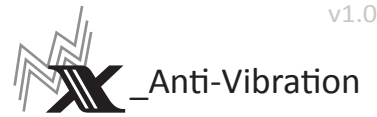

v1.0

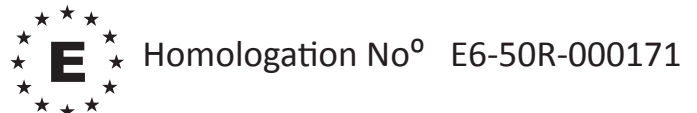

XENOLEN®

Technical Support : support@xenolen.com